

# EvoCharge App Key Features



A licensed electrician should have completed the installation of your EvoCharge charging station. Confirm that your charger is powered on.

## 1. Downloading EvoCharge App

Download the EvoCharge app by scanning the QR code below with your mobile device or searching for “EvoCharge” in the Apple App Store™ (for iPhones) or Google Play™ (for Android phones).



## 2. Account Setup

To set up an account in the EvoCharge app, select “Sign Up” on the login screen and follow the in-app instructions.

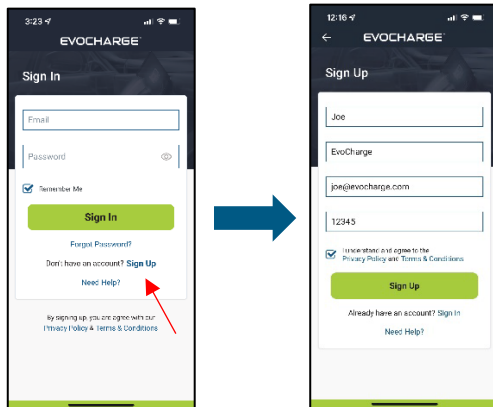

## 3. Add Charger to Users Account

1. To add a charger to your account login to the app and click on the “Add New Charger” button on the Home screen.

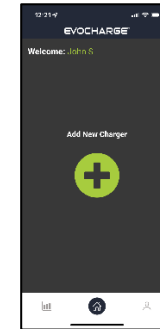

2. Follow the in-app instructions to connect the charger to your local 2.4Ghz Wi-Fi network. If you are unsure if your router is broadcasting a 2.4Ghz signal, check with your router provider.

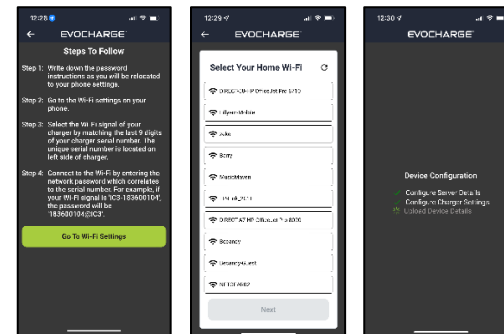

3. The charger will then reboot once all the onboarding steps have been completed. Please be patient, this will take a few minutes.  
4. Congratulations! You have completed connecting your charger to local Wi-Fi and the EvoCharge app.

## Schedule Charging

- Create a charging schedule that will automatically start your charging session
- Save money by scheduling charging during off-peak electric hours when electricity rates are low

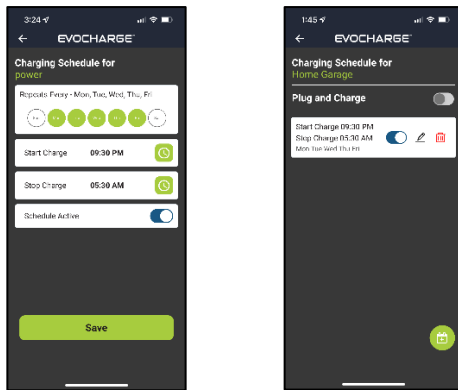

## Plug and Charge

- When Plug and Charge is turned on your vehicle will automatically start charging whenever it is plugged in
- This feature will disable your set charging schedules, but when Plug and Charge is turned off the schedules will become active again

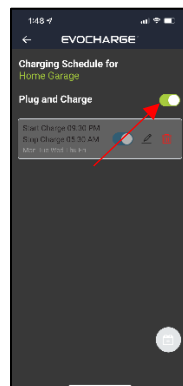

## Remote Start/Stop Charge

- Remotely start and stop a charging session by using the start/stop slider bar

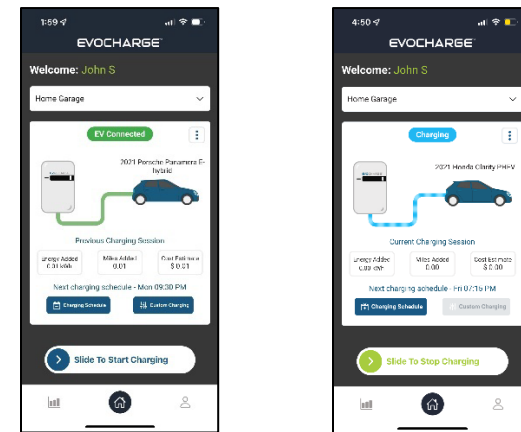

## Charging History

- View your previous charging sessions and see how much energy you are using to charge your vehicle
- Use the interactive chart to visualize your charging energy usage

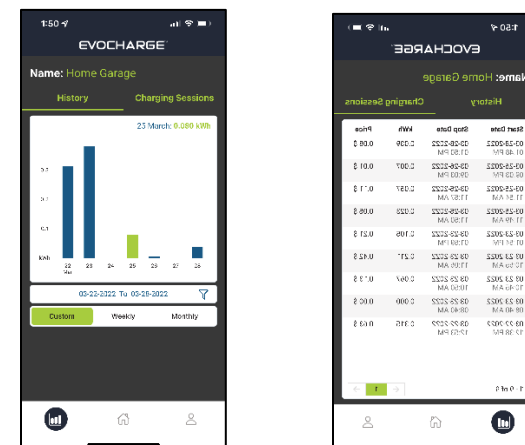

# EvoCharge App Key Features



## EV Garage

- Select the make, model, and year of your electric vehicle
- If your vehicle is not listed, you can add a custom vehicle with your EV's information

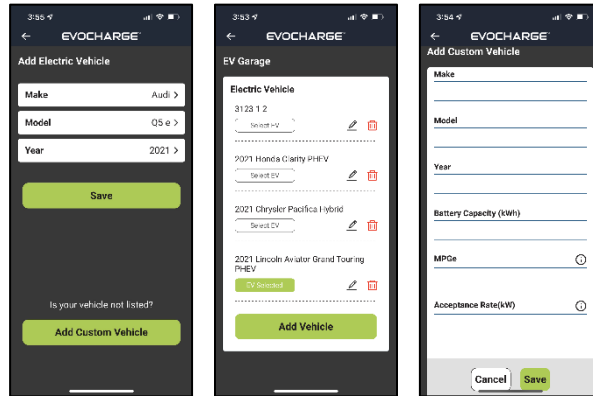

## Custom Charging

- Ability to start a charging session that will stop at a customized value of kWh's, Miles, or Battery % added

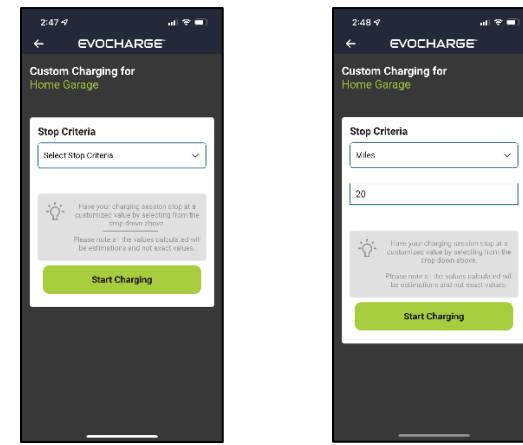

## Utility Pricing

- Manually enter your utility information to get estimates on the costs of charging sessions
- Option to set a Fixed Rate or Time-of-Use Rates

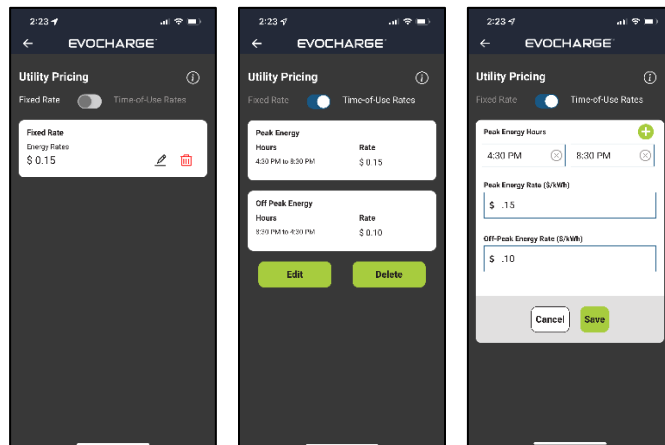

## Charger Sharing

- Invite up to 5 other users to share a single charger
- Each user will have access to start charging sessions, schedule charging, and review charging data

